

# Porthole $\varnothing$ 400 mm

fixed porthole

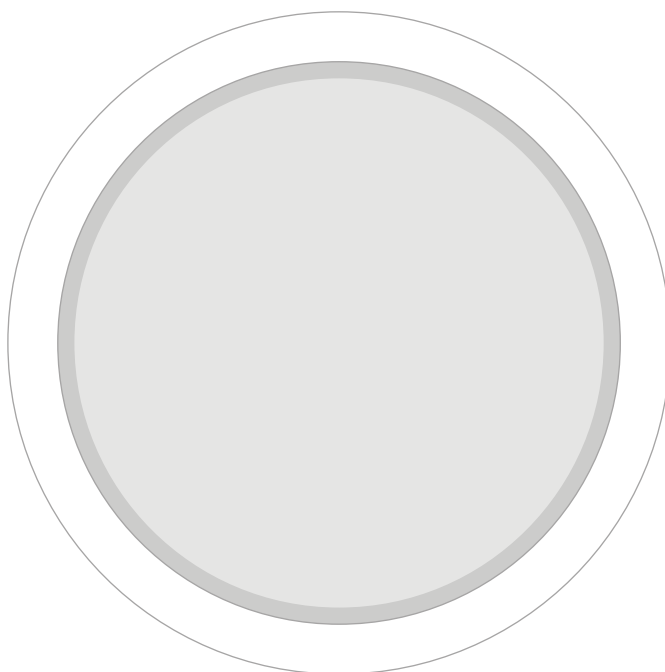

## Measurements

## Section

| <b>Fixed</b>        | <b><math>\varnothing</math> mm.</b> | <b>400</b> |
|---------------------|-------------------------------------|------------|
| A/ Exterior total   |                                     | 438        |
| B/ Glazing          |                                     | 372        |
| C/ Pane             |                                     | 350        |
| D/ Exterior window  |                                     | 402        |
| E/ Ext. Rough frame |                                     | 460        |
| F/ Frame thickness  |                                     | 49         |

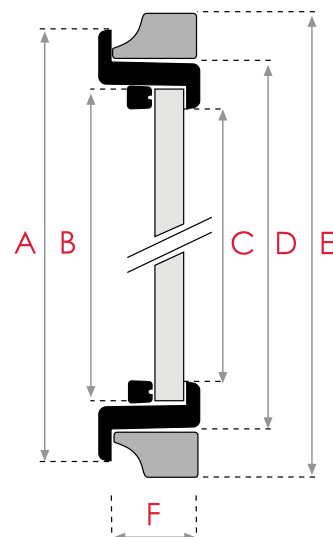

ojo de buey  $\varnothing$  400 mm

fijo

THE  
**Portholes**  
•.com

PATENTED PRODUCT

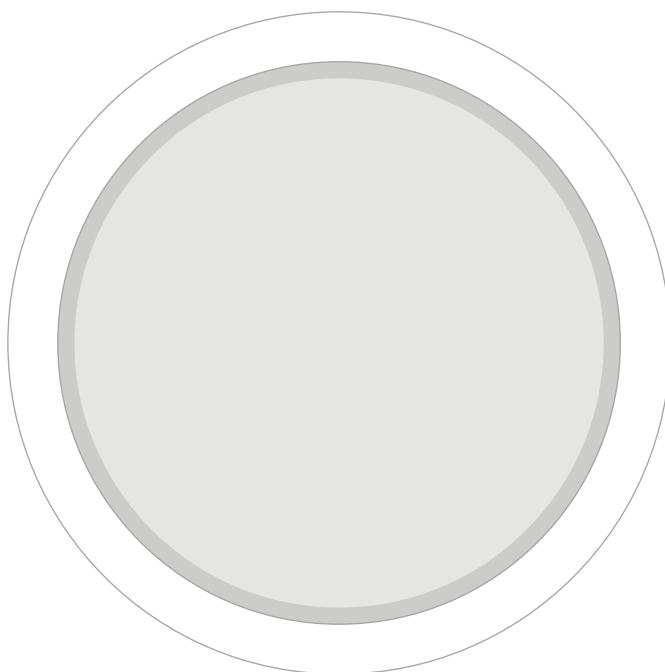

## Medidas

## Sección

**Fijo  $\varnothing$  mm.** **400**

|                      |     |
|----------------------|-----|
| A/ Exterior total    | 438 |
| B/ Del Vidrio        | 372 |
| C/ Luz               | 350 |
| D/ Exterior Ventana  | 402 |
| E/ Exterior Precerco | 460 |
| F/ Espesor del Marco | 49  |

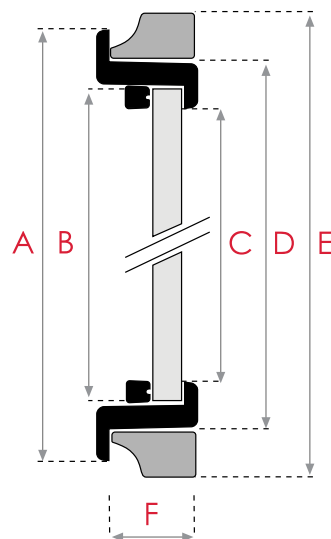

# Oeil de boeuf $\varnothing$ 400 mm

fixe

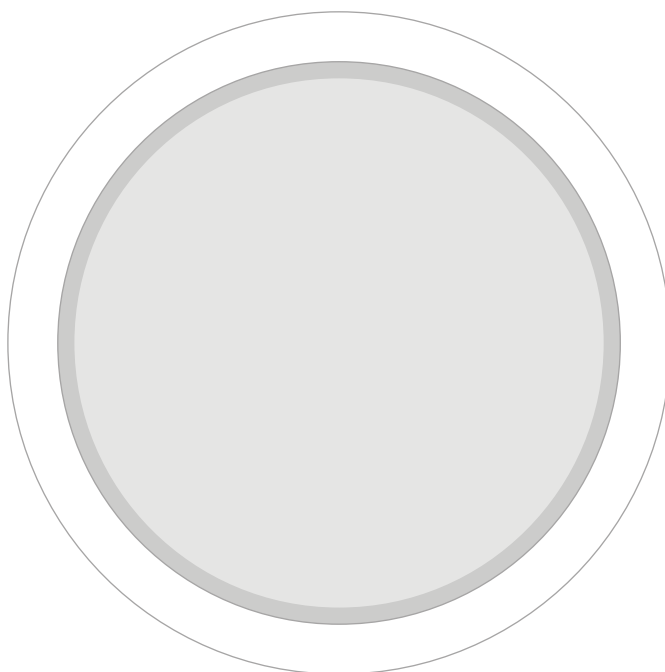

## Dimensions

|  |            |
|--|------------|
| <b>Fixe <math>\varnothing</math> mm.</b> | <b>400</b> |
| A/ Extérieur total                       | 438        |
| B/ Vitrage                               | 372        |
| C/ Clair de Vitrage                      | 350        |
| D/ Extérieur Fenêtre                     | 402        |
| E/ Ext. Pré-encadr.                      | 460        |
| F/ Épaisseur du Cadre                    | 49         |

## Plan de coupe

